

**Cutter Repair Kit**  
for Rio Blenders



**⚠ WARNING**



**Cut Hazard**  
Handle cutter  
assembly with  
care.  
Failure to follow  
these instructions  
can result in cuts  
or other injuries.

**Removing the  
old cutter assembly**

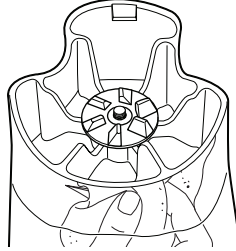

Hold the blades with a  
cloth. Unscrew the clutch  
counterclockwise.

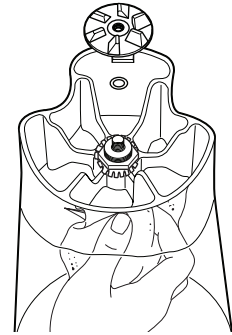

Remove the clutch and  
felt washer.



Remove the shaft and  
blade assembly

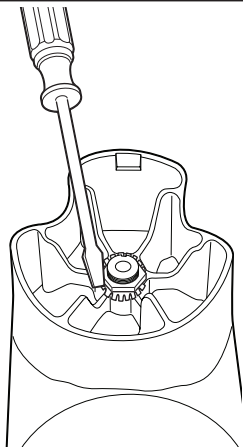

Use a flathead screw-  
driver to flatten the tabs  
on the tab washer.

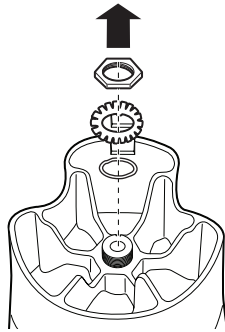

Remove the nut by  
turning counterclockwise  
by hand. Then remove  
the tab washer and  
pressure washer.

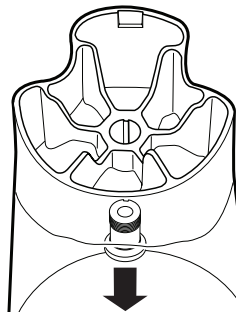

Remove bushing.

**Installing the  
new cutter assembly**

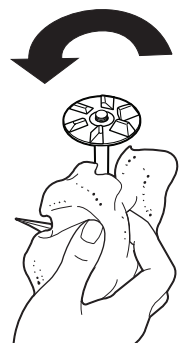

Hold the blades with a cloth. Unscrew the clutch counterclockwise.

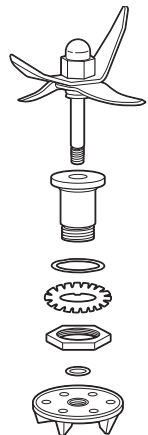

Disassemble the new cutter assembly.

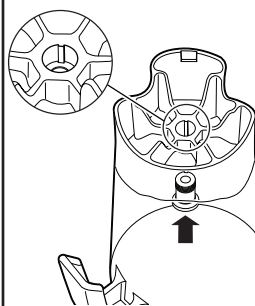

Align the groove in the bushing with the rib on the pitcher and press into place from inside the pitcher.

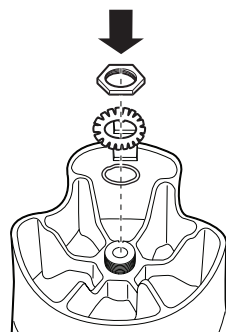

Install the pressure washer, tab washer, and retainer nut by hand. Do NOT overtighten the retainer nut!

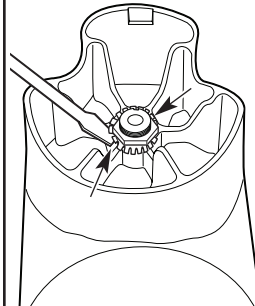

Use a flathead screwdriver to bend up two opposing tabs on the tab washer.

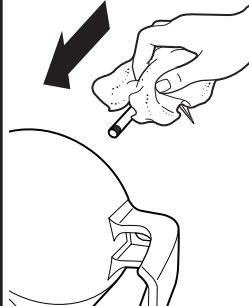

Install the shaft and blades

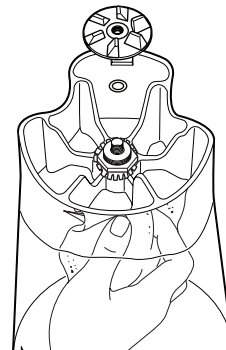

Install the felt washer and clutch.

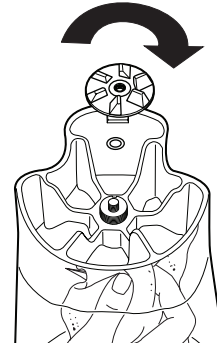

Tighten the clutch by turning it clockwise while holding the blades with a cloth.